



Instruction manual / Bedienungsanleitung  
 Manuel d'instructions / Manuale di istruzioni  
 Manual de instrucciones  
 Instructiehandleiding / 使用说明书

## FIRST Fire **CE** **RoHS** [PET-4200]

This product may be changed without prior notice

### WARRANTY

**OPPAMA'S RESPONSIBILITY**  
 Oppama warrants that this device is produced under strict quality control and has passed the quality inspection.  
 Only under normal use and maintenance from date of purchase.  
 Oppama Industry agrees to repair or replace any defective product for free by Oppama's discretion at the dealer where you purchased it within 90 days period.  
 This limited warranty is extended to the original purchaser only, and it is not transferable to following owners.

Date of Purchase: \_\_\_\_\_  
 Name: \_\_\_\_\_ Phone: \_\_\_\_\_  
 Address: \_\_\_\_\_  
 Retailer: \_\_\_\_\_

# SAMPLE

IMPORTANT: Please be sure to complete this WARRANTY card at the time of purchase and keep it. The WARRANTY card cannot be reissued under any circumstances.



THIS WARRANTY IS PROVIDED BY  
**OPPAMA INDUSTRY CO., LTD.**  
 14-2, Natsushicho, Yokosuka, Kanagawa 237-0061, JAPAN  
 Phone: +81-46-866-2130 Telefax: +81-46-866-3090  
 mail: info@oppama.co.jp https://www.oppama.co.jp/

### HOW TO USE

Place light area near the spark plug or the spark plug cable.

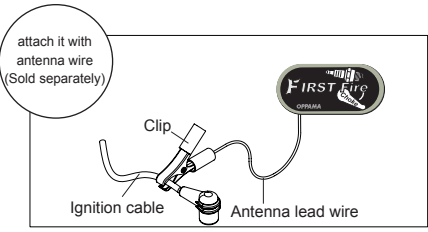
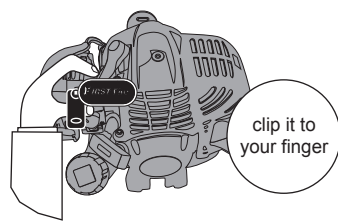
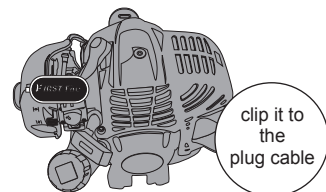

### FUNCTION

This device has two functions: it detects the sparking noise made by the spark plug of a gasoline engine, and it blinks or lights LED lamps.  
 A blinking LED indicates that necessary power for ignition is being supplied, while a lit LED indicates to the operator when to reset the choke during startup.  
 This device can be used to diagnose problems with gasoline-driven engines and assist in choke operation timing during startup.

### NAME OF PARTS

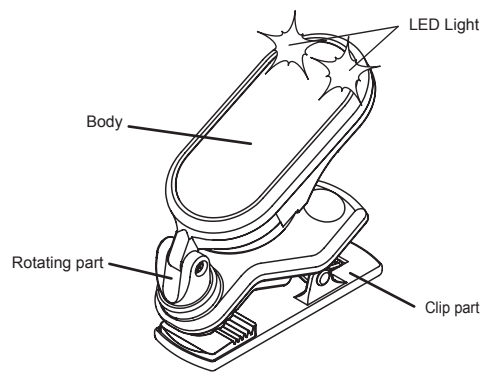

### Detail of function

#### Engine won't start? PET-4200 checks the electrical supply to the spark plug

- You can use a PET-4200 to diagnose your gasoline engine when it won't start.
- You don't even need to take off the spark plug; just put the device near the spark plug cable.
- The orange LED lamp will light up if your spark plug is successfully receiving electricity.

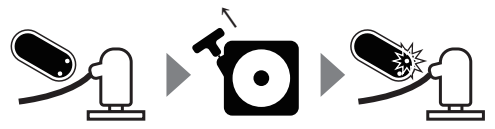

※Please make sure the stop switch to the state where the engine can start.

#### Notification of choke return timing on engine start

- Put the PET-4200 near the spark plug cable, then start the engine.
- When the green LED is lit, return the choke (open position).
- Future engine starts will be made very easy.

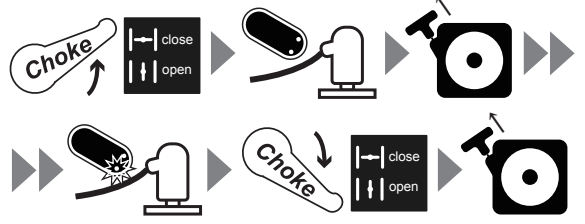

※Please make sure the stop switch to the state where the engine can start.

### SPECIFICATION

MODEL NAME	PET-4200
Applicable Engines	All gasoline engines ※
Ignition detection	When the device detects ignition, the orange LED will blink.
Choke release timing notifier	Green LED lights up for appr. 3 seconds when the device detects the first firing sound.
Battery Life	Appr. 1 year with use of 5 minutes per day (uses 1x CR2032 battery) ※
Ambient Temperature	-10°C ~ +60°C
Dimensions(L × W × H)	40×70×30 mm
Weight	30g
Accessories	Operation manual : 1 copy
Sold separately	Antenna lead wire : 1 set

※This unit cannot be used for diesel engines and direct ignition engine.  
 ※The included battery has been tested and is functional, but its voltage may be below standard specifications.

This device complies with Part 15 of the FCC Rules. Operation is subject to the following two conditions: (1) This device may not cause harmful interference, and (2) this device must accept any interference, including interference that may cause undesired operation.

### Characteristic

Attach clip to handle/shaft

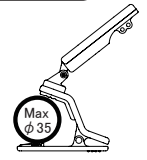

Freely-adjustable

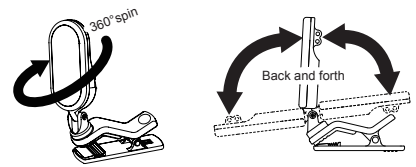

### Replacing the battery

If you feel your LEDs are too dim, you should change the battery. Remove the back battery cover and replace your device's CR2032 battery.

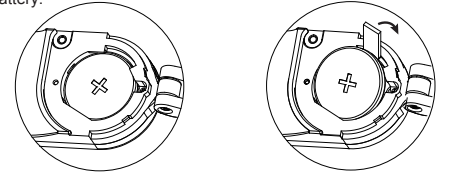

- Remove the back cover.
- Push a flat, firm object into the slot to pop out the battery.
- Place the new battery in, being careful of the battery's direction, and replace the cover.

### What is the first firing sound

When starting your engine with a recoil starter, you close the choke before pulling the recoil starter. This triggers an explosive ignition as the engine makes a revving sound; this is called the "first firing sound".

With some engines, it's very hard to figure out when to open the choke. If you open too late, you could douse your spark plug, and that'll make it even harder to start your engine. The PET-4200 senses the first firing sound electronically, notifying you with an LED lamp so that you can easily open the choke at the right time. It makes starting gasoline-powered engines a breeze.

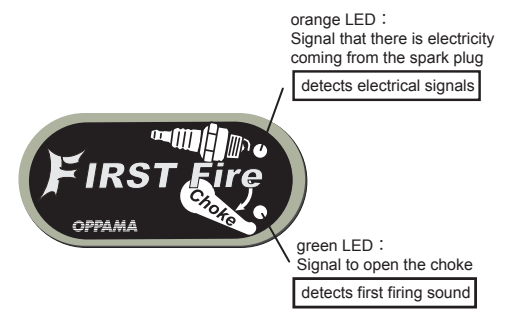

### NOTE

This equipment has been tested and found to comply with the limits for a Class A digital device, pursuant to part 15 of the FCC Rules. These limits are designed to provide reasonable protection against harmful interference when the equipment is operated in a commercial environment. This equipment generates, uses and can radiate radio frequency energy and, if not installed and used in accordance with the instruction manual, may cause harmful interference to radio communications. Operation of this equipment in a residential area is likely to cause harmful interference in which case the user will be required to correct the interference at his own expense.

### CAUTION

- Always follow your engine's operation manual for how to start your engine.
- Some engines may not be compatible with the PET-4200's first firing sound detection functionality.
- It is proof against rain and splash but not for use underwater. When it gets wet, wipe it promptly with dried cloth.
- Keep this unit away from strong physical shocks.
- This unit cannot be disassembled. (Except battery replacement part.)
- If there is any doubt that the PET-4200 broke down, first, operate the device following the instruction manual. If it cannot be fixed, please contact the dealer where you purchased the unit or Oppama Industry Co.,Ltd. We are not responsible for any damage caused by the unreasonable repair or disassembly of device by yourself or third party.
- Use plug with resistor. Use of non-resistor plugs may result in a violent ignition noise that can damage your device.
- Any changes or modifications not expressly approved by the party responsible for compliance could void the user's authority to operate the equipment.